

KiCA 3

Massage Device Instructions

EN V1.0

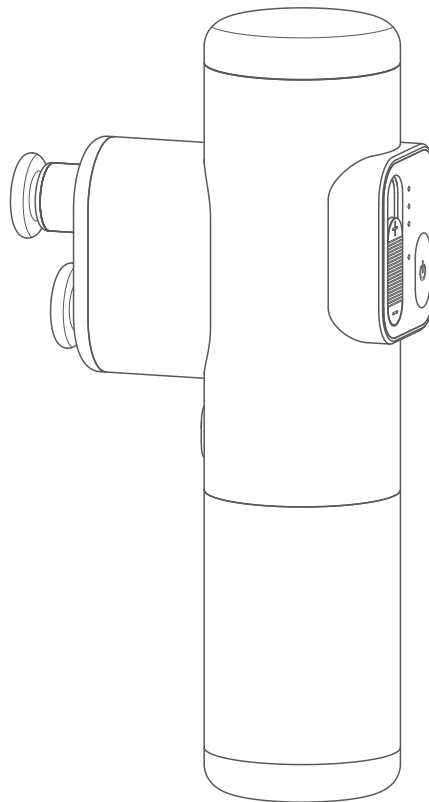

Overview

- [1] Gear button
- [2] Mode indicator
- [3] Battery indicator
- [4] Power button/Mode button
- [5] Charging port
- [6] Flat head (Non-removable)
- [7] Trigger button

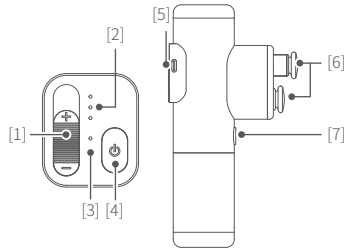

2. Power ON / Start running / Power Off

Power ON:

Long press the power button until hear the tone.

Start running:

The device will start running after powering on, single tap trigger button to stop.

Single tap again to restart.

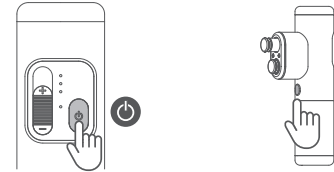

Do not touch the middle and the back of the two massage heads while the product is running to avoid injuries.

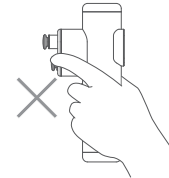

Power Off:

Long press the power button until hear the tone to power off.

If there is no operation within 10 minutes, it will power off automatically.

3. Massage modes

Single tap mode button to switch modes cyclically.

Slide the gear button to adjust rotate speed.

Flat Head:



Massage flat major muscle groups on the back.



Gentle Head:

Promote the absorption of essential oil.



Spherical Head:

Relax soft tissues and sensitive muscles.



U-shaped Head:

Massage neck (not cervical vertebrae) and tendon.

Start to Use

1. Massage Head Combination

The device can be used directly with the built-in massage head (two flat head), on it, or combine with another one depending on your needs. See complete combination as below.

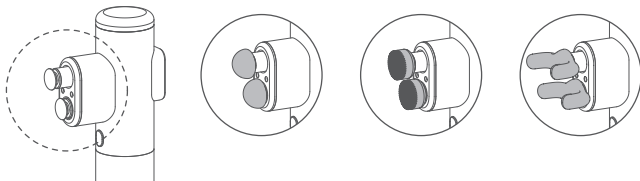

Mode	Rated rotate speed (rpm)	Gear Indicator
Vibration mode	500-2600	☀ ● ● ●
Percussion mode	50-450	☀ ☀ ● ● ●
Kneading mode	100-900	☀ ● ● ● ●

4. Locked Motor Protection

 Do not press the massage head firmly to block the motor rotation while using, otherwise it will reduce the service life of the product!

This product has locked motor protection function. If the rotation is blocked for 3 seconds, it will stop running automatically after a beep sound. Single tap the trigger button to start again.

5. Intelligent Protection

This product has intelligent protection function. After working for 10 minutes continuously, a beep sound will be issued, and the product will stop running automatically. Single tap the trigger button to start again.

6. Battery Indicator

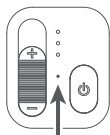

Battery indicator

Indicator while using	Description
Indicator light off	Fully charged
Indicator light flashes	Need recharging
Turn off after indicator light flashes	Low power, will auto power off
Indicator while charging	Description
Constant red light	Charging
Constant green light	Charge completed

7. Charging

 Do not use it while charging.

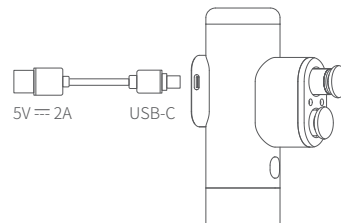

8. Specifications

Product Name: KiCA 3 Massage Device

Product Model: A3S

Operating Voltage Range: 10.8V~12.6V

Operating Temperature Range: 0°C ~+40°C

Charging Temperature Range: 0°C ~+40°C

Battery Capacity: 2200mAh

Charging Time: About 4.5 hours

Weight: About 614g

Size: 97.4×46×182.8mm

Theoretical Battery Life: About 20 hours (flat head, kneading, low speed)

List

- ① KiCA 3 ×1
- ② Storage Bag ×1
- ③ Spherical Head ×2
- ④ Gentle Head ×2
- ⑤ U-shaped Head ×2
- ⑥ USB-C Cable ×1
- ⑦ Manual ×1

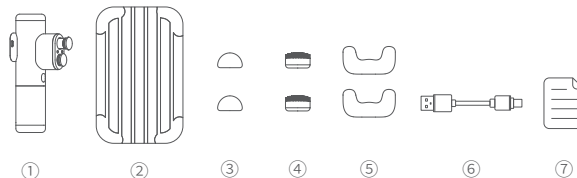

Contraindications

1. Cancers
2. Metal bone anastomosis (do not use the device directly in the fracture area)
3. Osteoporosis
4. Vein thrombosis and pulsation
5. Hypertension
6. Pregnant woman
7. Varicose veins
8. Acute inflammation
9. Do not massage the bony area
10. Do not massage surgical site
11. Do not massage the cervical vertebrae and spine
12. Kidney stones (do not use the device near the kidneys)
13. Do not massage one episode for more than 5 minutes

Safety Instruction

1. It is recommend to massage your body after wearing dry clothes or placing a clean and dry towel on massage part, then gently press and move the device.
2. High-speed and high-pressure massage can only be used to soft tissues without feeling pain or maladjustments. Do not massage head and any skeletal sites with high speed and high pressure.
3. Massage the same part of the body with high speed and high pressure for a long time will.
4. Please keep your fingers, hair or, any other body hair away from the extendable part of the device to prevent pinching and clipping.
5. Do not discard or misuse this device.
6. Do not modify this device by yourself without permission.
7. Do not operate or charge the device when nobody was around.
8. This device is for adults only.
9. People with contraindicated symptoms should use this device with doctor's permission.

Notice

1. Make sure the massage head is not blocked by external force when the device is power on. If it is blocked, it will pause for a while and try to restart.
2. DO NOT contact the product with water or other liquid for the massage device is not waterproof.
3. DO NOT disassemble the product except marked detachable. It need send to after-sales or authorized service center to fix it if you accidentally disassemble it and cause abnormal work. The relevant costs are borne by users.
4. Prolonged continuous operation may cause the motor surface temperature to rise, please operate carefully.
5. DO NOT drop or strike the product. If the product is abnormal, contact After-sales support.

Storage and Maintenance

1. Keep the product out of the reach of children and pets.
2. DO NOT leave the product near heat sources such as a furnace or heater. DO NOT leave the product inside of a vehicle on hot days.
3. Please storage the product in a dry environment.
4. DO NOT overcharge or overuse the battery, otherwise, it will cause damage to the battery core.
5. Never use the product when the temperature is too high or too low.

Precautions when discarding the product

The lithium ion battery used by the product is a recyclable and renewable valuable resource.

When discarding it, please have it handled by a professional agency that can recycle chargeable batteries. Before discarding the product, power it off and take the lithium ion battery out from it following the steps below. The battery is to be disposed of safely.

1. Disassemble the top housing with help of a professional tool.
2. Pull out the batter terminals from the PCBA.
3. Use a professional cutter to cut off the bottom housing and then take out the battery.

This document is subject to change without notice.